

PLASTABRICK CLAD

DESCRIPTION

40mm or 60mm Cavity Based EIFS System

SYSTEM GUARANTEE PERIOD

15 years

WORKMANSHIP GUARANTEE

5 years



BRANZ Appraised
Appraisal No.597 [2008]

SYSTEM CONSTRUCTION:

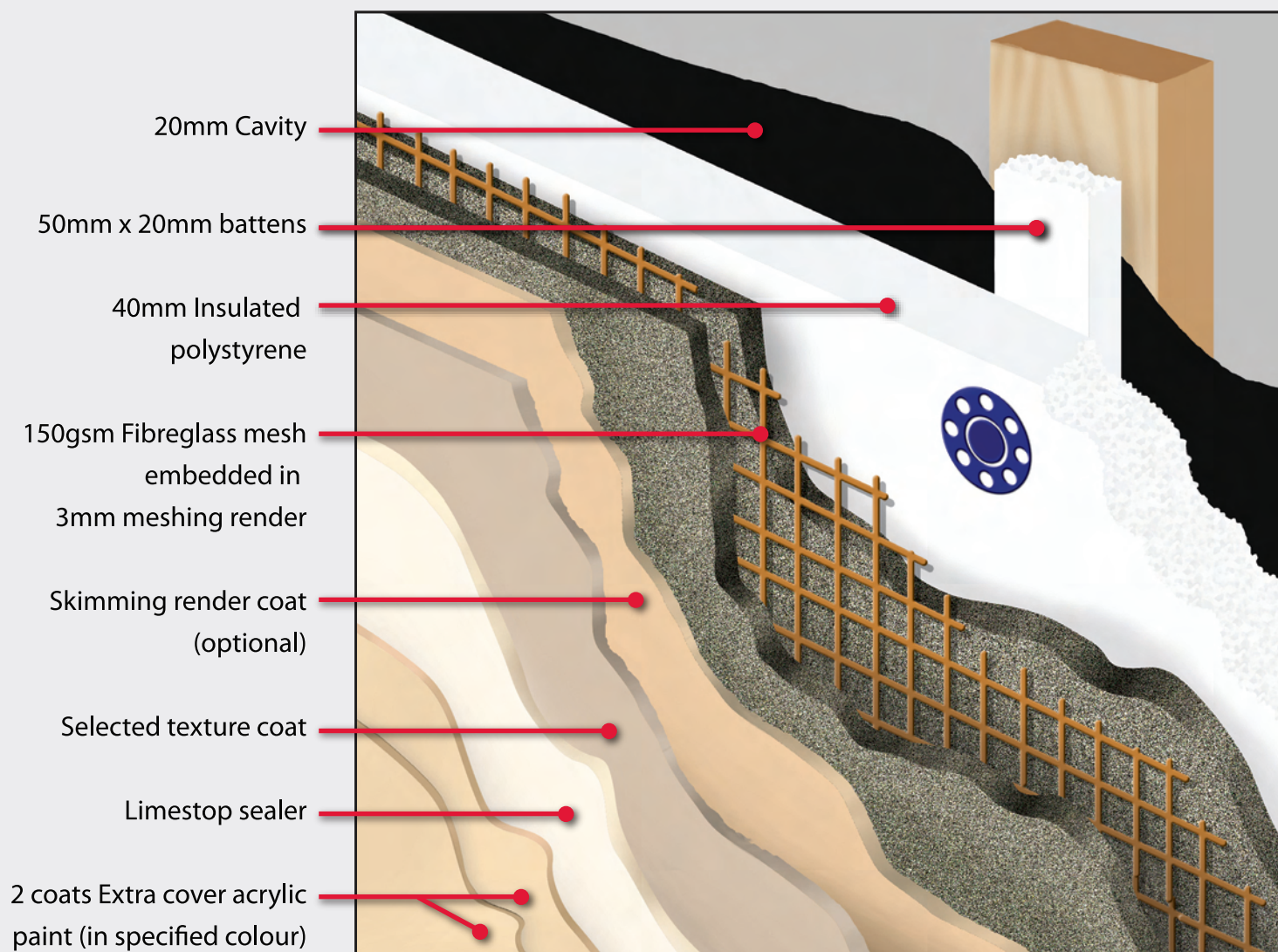

PLASTACLAD

WHAT IS PLASTACLAD?

PlastaClad has a crack resistant exterior plaster cladding system that provides a fully drained and ventilated weatherproof barrier for residential and commercial construction. Developed specifically to meet the harsh requirements of New Zealand's coastal environment, the cavity behind Plastaclad provides an additional safeguard to ensure any moisture that may penetrate the exterior envelope is able to escape unimpeded. To ensure there is a well-defined chain of accountability, the installation of the Plastaclad system, including the construction of the 20mm cavity, can only be undertaken by licensed Plastabrick installer.

ADVANTAGES

The PlastaClad System is extremely lightweight (approximately 7kg per m²) it is well suited to pole structures or areas with poor quality soils and foundations. This characteristic can also reduce the cost of supporting structural elements such as beams and columns. It also does not require a base footing of concrete in order to support its own weight, which can save money on foundation work.

APPLICATION

Meshing Render

Use premeshed corner beads on all external corners. Use meshing render or adhesive to fix premeshed corner beads. Apply meshing render plaster coat 3mm minimum. Embed fiberglass mesh into the wet plaster. Overlap each successive length by 50mm minimum. To opening reveals mesh over the uPVC flashings. Apply diagonal reinforcement strips at all corners of windows, doors and other exterior openings.

Flushing

A coat of Skimming render can be applied in a thin application to ensure plaster is forced into the surface and then brought out to a flush finish with extra product. This coat is optional.

Texture Finish

Apply the coating of the selected texture, to the Plastabrick recommended techniques and thicknesses.

Cure Finish

Cure and protect from rapid drying in accordance with Plastabrick requirements.

Paint Finish

Apply one coat of limestop plaster sealer and then two coats of Extra cover 100% acrylic paint to exterior plastered surfaces. Allow a minimum of 3 days for the cement plaster to dry before the application of the paint system.

Darker colors heat up in the sun and can cause problems with expansion and contraction of the surface and for this reason PlastaClad restrict colour depth to a LRV of 25% or more for guarantee purposes,